



NUSZER KOPATZ
urban design associates
1117 Cherokee Street
Denver, Colorado 80204
phone 303.534.3881
fax 303.534.3884
www.nuszer-kopatz.com

ASBURY GREEN
2400 E. ASBURY, DENVER, CO 80210
MACKENZIE HOUSE

DRW

GKL/CH

CHK

JFR/KM

REVISIONS

NO.	DESCRIPTION	DATE
1	ADDENDUM 1	2/14/08
2	ADDENDUM 2	3/30/08
3		
4		
5		
6		

ISSUE RECORD

NO.	DESCRIPTION	DATE
1	DESIGN DEVELOPMENT	11/16/07
2	FOUNDATION PERMIT	12/10/07
3	FINAL CONSTRUCTION DOCUMENTS	01/08/08
4	FINAL CONSTRUCTION DOCUMENTS	03/06/08
5		
6		

SHEET CONTENTS:
LIGHTING PLAN

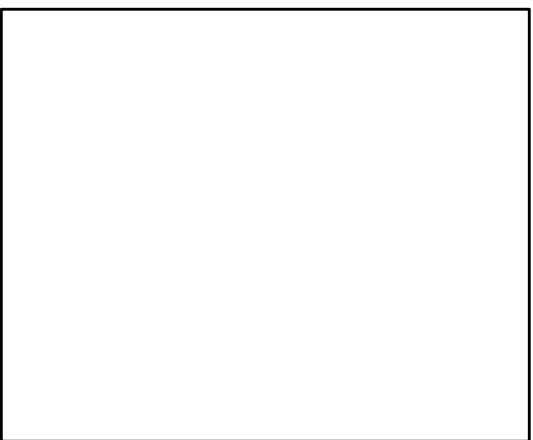

PROJ. NUMBER: 030709
DATE: 03.06.08

DRAWING NUMBER:
LP1

LIGHTING NOTES:

- CONTRACTOR TO PROVIDE APPROPRIATE ELECTRICAL SERVICE CONNECTION.
- OWNER WILL PROVIDE POWER SERVICE LINE WITHIN LIMIT OF WORK.
- ELECTRICAL SERVICE SHALL BE FIELD COORDINATED.
- ALL LIGHTS SHALL BE FULL CUTOFF/ DOWNCAST.
- SHOP DRAWINGS FOR ALL SITE LIGHTING NEED TO BE PRODUCED BY THE ELECTRICAL ENGINEER AND LOCATION OF ALL SITE LIGHTING TO BE PROVIDED ON ALL LANDSCAPE LIGHTING PLANS.

GENERAL NOTES:

1. ANY DEVIATIONS FROM OR MODIFICATIONS OF LAYOUT AND DIMENSIONS SHOWN ON THIS PLAN SHALL REQUIRE PRIOR APPROVAL BY THE OWNER'S REPRESENTATIVE.
2. THE CONTRACTOR SHALL BE RESPONSIBLE FOR ALL PERMITS, FEES, AND LICENSES ASSOCIATED WITH THE WORK AS SHOWN ON THE DRAWINGS.
3. THE CONTRACTOR SHALL BE RESPONSIBLE FOR THE SCHEDULING AND COORDINATION OF ALL REQUIRED INSPECTIONS WITH ALL GOVERNING JURISDICTIONS.

SYMBOL	LIGHTING LEGEND
	STREET LIGHT
	GUY-WIRE LIGHT
	BOLLARD LIGHT
	WALL MOUNTED LIGHT
	TRELLIS LIGHT
	GUY-WIRE
	POINT OF BEGINNING



1 STREET LIGHT (3)

KIM LIGHTING CURVILINEAR CUTOFF
LIGHT TYPE: 750PMH120
POLE HEIGHT: 35', TAPERED FIBERGLASS POLE W/ 8"
BRACKET ARM
COLOR: FEDERAL GREEN (FEDERAL COLOR #: 14056)
CONTACT: STEVE BARRETT, MH LIGHTING -
(303) 573-0222

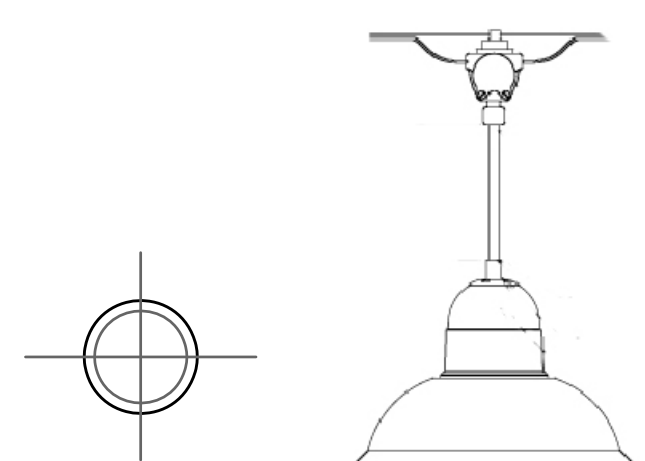

2 GUY - WIRE LIGHT (3)

ARCHITECTURAL AREA LIGHTING
FULL CUTOFF, DOWN CAST
COLOR: BLACK
MOUNTING HEIGHT: 15'
100 WATT MH
PRODUCT/CATALOGUE #:
LUM-BEL-H3-FTG 08A-1169
CONTACT: STEVE BARRETT, MH LIGHTING -
(303) 573-0222
GUY-WIRE: 3/8"



3 BOLLARD LIGHT (14)

KIM ROUND BOLLARD
COLOR: BLACK
HEIGHT: 42"
26 WATT CFL
SURFACE MOUNTED
PRODUCT/CATALOGUE # : KIM-VRB1/42PL/BL-P
CONTACT: STEVE BARRETT, MH LIGHTING - (303) 573-0222

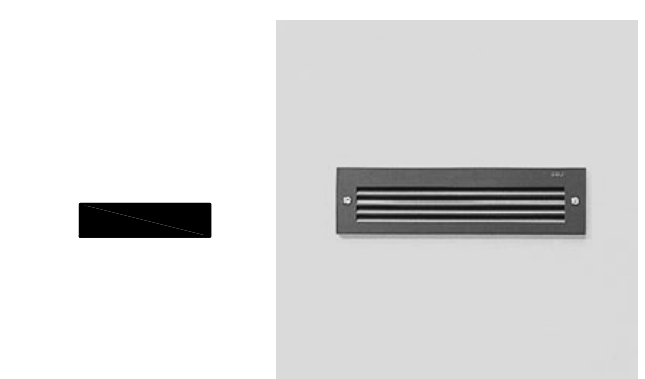

4 WALL MOUNTED LIGHT (10)

BEGA RECESSED WALL LUMINAIRE
COLOR: BLACK
13 WATT CFL
PRODUCT/CATALOGUE #: 2286P
CONTACT: STEVE BARRETT, MH LIGHTING -
(303) 573-0222

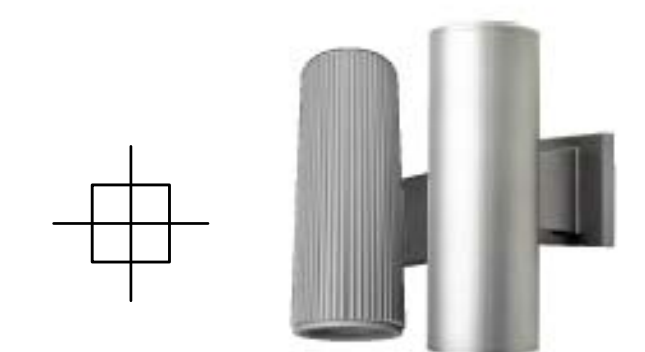

5 TRELLIS LIGHT (2)

PRESCOLITE WALL MOUNT CYLINDER
4" DIRECT LED
COLOR: BLACK
LED LIGHTING
PRODUCT/CATALOGUE #: LD4-S-D-W-BL
CONTACT: STEVE BARRETT, MH LIGHTING -
(303) 573-0222
REFER TO TRELLIS DETAIL FOR LIGHT LOCATION

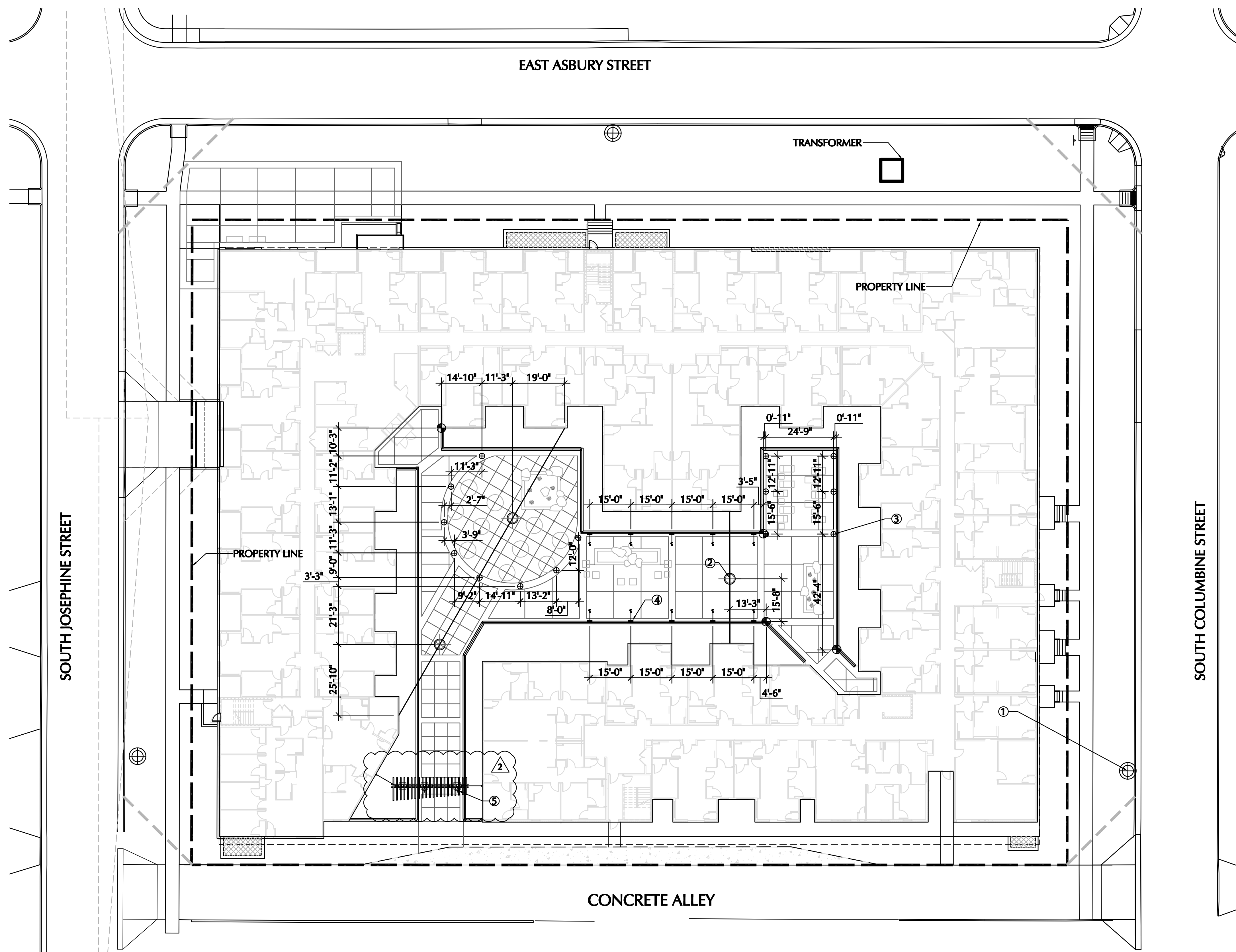

1 LIGHTING PLAN

SCALE: 1"=20'

