

Dec 09, 2008 3:25:49pm - User: diego
C:\Users\diego\Documents\14026201_C102-LED BIKE ROUTE.DWG
Xrefs: (UNRESOLVED) (UNRESOLVED)

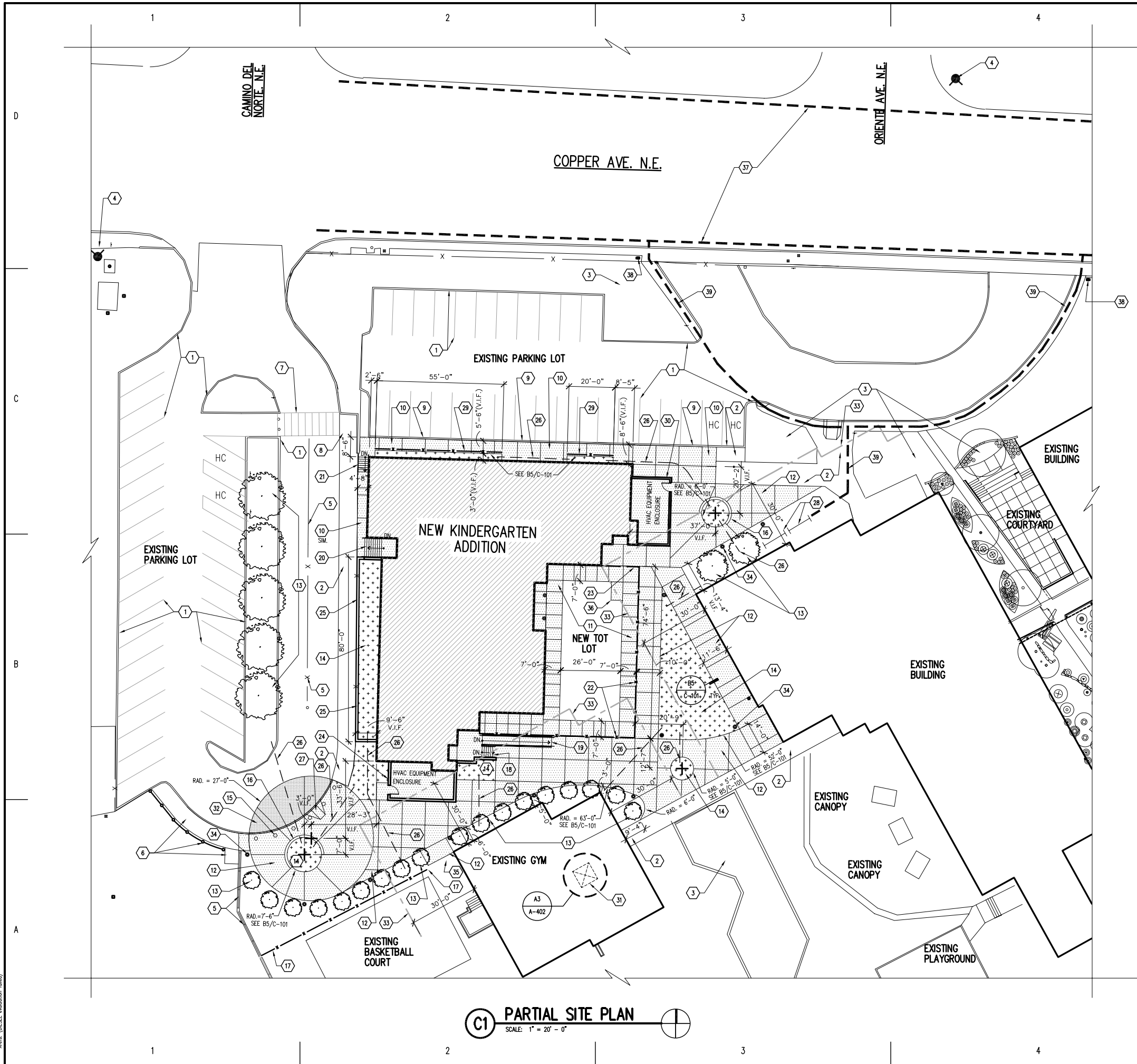

SHEET KEYNOTES

- EXISTING PARKING LOT, CONCRETE CURBS, AND STRIPING.
- EXISTING CONCRETE SIDEWALK.
- EXISTING LANDSCAPING.
- EXISTING FIRE HYDRANT. (SHOWN FOR CITY OF ALBUQUERQUE FIRE MARSHAL PLAN REVIEWER REFERENCE) SEE SHEET C-101 FOR LOCATION OF A TOTAL OF 4 HYDRANTS WHICH ARE ON OR NEAR SITE.
- EXISTING CHAINLINK FENCE.
- CONCRETE SIDEWALK, RAMP AND FENCING TO REMAIN AT THIS LOCATION. SEE C-101 FOR CONSTRUCTION.
- EXISTING CROSSWALK STRIPING.
- EXISTING HANDICAP RAMP.
- EXISTING CONCRETE CURB.
- NEW 4" THICK, 4000 PSI, AIR-ENTRAINED CONC. SIDEWALK FLUSH WITH TOP OF EXISTING CURB OVER SUBGRADE COMPACTED TO 95% OF MAX. DENSITY. CONTROLS JOINTS AT 10'-0" O.C. TYP.
- NEW 5" THICK, 4000 PSI, AIR-ENTRAINED CONCRETE SIDEWALK OVER SUBGRADE COMPACTED TO 95% OF MAX. DENSITY. CONTROL JOINTS AT 5'-0" O.C., TYP.
- NEW 4" THICK, 4000 PSI, AIR-ENTRAINED CONCRETE PAVING OVER SUBGRADE COMPACTED TO 95% OF MAX. DENSITY. CONTROL JOINTS AT 10'-0" O.C., TYP.
- NEW TREES BY OWNER.(NOT IN CONTRACT)
- NEW LANDSCAPING BY OWNER.(NOT IN CONTRACT)
- NEW 12" DIAMETER CONCRETE BOLLARD.(TYPICAL OF 6) SEE DETAIL A1/C-106.
- NEW CONCRETE BENCH. SEE DETAIL A2/C-106.
- NEW 10'-0" HIGH CHAINLINK FENCE. APPROX. 80 FEET LONG, VERIFY IN FIELD.
- NEW STAIRS AND HANDRAILS. SEE DETAIL A3/C-106 AND A4/C-106.
- NEW CONCRETE RAMP AND HANDRAILS. SEE DETAILS B1/C-106 AND B3/C-106.
- NEW STAIRS AND HANDRAILS. SEE DETAILS C1/C-106 AND C2/C-106.
- NEW STAIRS AND HANDRAILS. SEE DETAILS C3 & C4/C-106 & C4/S-302 SIMILAR.
- NEW FENCING AROUND PERIMETER OF TOT LOT. SEE DETAIL D1/C-106 AND SEE A5/C-101 FOR RETAINING WALL BELOW FENCING.
- 5'-0" WIDE REMOVABLE RAIL SECTION. SEE DETAIL D2/C-106.
- NEW CONCRETE WALL. SEE DETAIL C4/S-302.
- NEW CONCRETE RETAINING WALL. SEE DETAIL B5/C-106.
- 2" PVC SLEEVE FOR FUTURE IRRIGATION SYSTEM. STUB UP TO GRADE AND CAP.
- NEW HANDICAP RAMP. SEE DETAIL D3/C-106.
- EXISTING TWO BIKE RACKS TO REMAIN. EACH BIKE RACK ACCOMMODATES NINE BIKES.
- NEW SCREEN FENCING. SEE DETAIL D1/C-106.
- NEW CMU WALL AT +8'-0" WITH BRICK VENEER AND PRECAST CONCRETE CAP.
- RENOVATION OF EXISTING SUPPLY ROOM TO NEW STAFF SHOWER AND RESTROOM. SEE A3/A-402, A4/A-102, AND A4/P-101.
- NEW 6" THICK, 4000 PSI, AIR-ENTRAINED CONCRETE PAVING OVER SUBGRADE COMPACTED TO 95% MAX. DENSITY. CONTROL JOINTS AS SHOWN.
- LINE REPRESENTS 30'-0" BUILDING SETBACK OF NEW CONSTRUCTION FROM EXISTING CONSTRUCTION.
- NEW LIGHT POLE. (TOTAL OF 11) SEE ELECTRICAL DRAWINGS.
- 15'-0" WIDE OPENING IN BETWEEN EXISTING BUILDING AND NEW FENCE. (V.I.F.)
- 5" THICK x 5'-0" WIDE x 8'-0" LONG CONCRETE RAMP. 4000 PSI CONCRETE. SLOPE AT 1:16. SEE A4/S-302, SIMILAR & B1/S-501, SIMILAR.
- EXISTING CITY OF ALBUQUERQUE DEDICATED BIKE LANES.
- NEW POSTED SIGNAGE "DISMOUNT BICYCLE" AT THIS LOCATION.
- AFTER BICYCLERS DISMOUNT THEIR BIKE THEY WILL WALK THEIR BIKES ON SITE TO EXISTING BIKE RACKS.

LEGEND

- NEW 4" CONCRETE SIDEWALK AND CONCRETE PAVING
- NEW 6" CONCRETE PAVING
- NEW LANDSCAPING BY OWNER(NOT IN CONTRACT)
- NEW TREES BY OWNER(NOT IN CONTRACT)
- 30'-0" BUILDING SETBACK OF NEW CONSTRUCTION FROM EXISTING CONSTRUCTION
- BIKE ROUTE
- 2" PVC SLEEVE FOR FUTURE IRRIGATION SYSTEM

**HUNT
ZOLLARS**

Hunt-Zollars, Inc.
6501 Americas Parkway NE,
Suite 550
Albuquerque, N. M. 87110
Phone (505) 883-8114
Fax (505) 883-5022

**ALBUQUERQUE
PUBLIC SCHOOLS**

Apache
Elementary
School

Kindergarten
Addition

ADDRESS:
12800 COPPER AVE. NE
ALBUQUERQUE NM
87123

CD	DATE	DESCRIPTION
01	12/01/08	BIDDING DOCUMENTS
02	09/30/08	95% REVIEW SUBMITTAL
03	07/22/08	50% REVIEW SUBMITTAL

MARK DATE DESCRIPTION
ISSUE:

PROJECT NO.: 14026201
CAD DWG FILE: C-102.dwg

DRAWN BY: DLS
CHECKED BY: JJ

COPYRIGHT:
HUNT-ZOLLARS INC. 2008

SHEET TITLE:

**PARTIAL
SITE PLAN**

C-102

SHEET OF