



4" Direct/Indirect LED Wall Mount Cylinder **LD4**

Wet Location
120V

DATE: _____ TYPE: _____

FIRM NAME: _____

PROJECT: _____

LiteForms®

For conversion to millimeters,
multiply inches by 25.4
Not to Scale

APPLICATIONS:

The LD4 is a 4" direct/indirect wall mount cylinder to achieve illumination patterns on vertical walls or columns. The LD4 is suitable for a wide variety of commercial, retail and institutional applications including building exterior, column, and corridor illumination. Fixture should be installed in applications where ambient temperatures do not exceed 50°C (122°F). Installations in applications that exceed this temperature will result in a reduction of lamp life.

HOUSING:

.125" thick seamless extruded aluminum cylinder with diecast aluminum, arm, and mounting bracket. Interlocking parts insure proper cylinder alignment. Gasketed die cast lens ring is threaded to screw into cylinder for snug fit. The rings are provided with anti-rotation set screws that lock them in place. Durable powder coated paint finish. Specify: matte black, matte white or Prescolite's exclusive Zet, metallic silver. All components are non-corrosive.

LEDs:

Each array is equipped with (6) 1 watt emitters with integral heat sink that will provide 70% average lumen maintenance at 50,000 hours. White LEDs shipped standard with a color corrective spread lens(es) that adjust the color temperature of the fixture to ~ 4,100K. All other colors shipped with clear solite spread lens.

The power for the LEDs is 15.6W per LD4UD fixture and 7.8W per LD4D fixture. (This is calculated with the highest forward voltage.)

DRIVER:

Solid state electronic 700 ma, FCC class B compliant, 24V, .2A max. 50,000 hour minimum anticipated life. Rated for -40°C/F starting temperature.

LABELS:

CSA C/US Suitable for wet location.

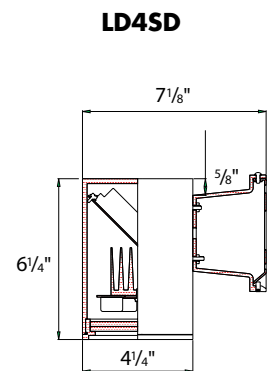
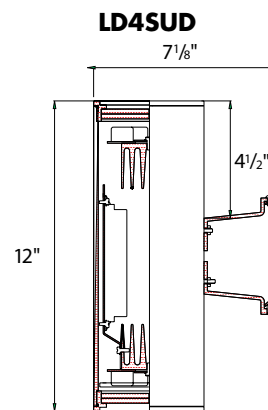
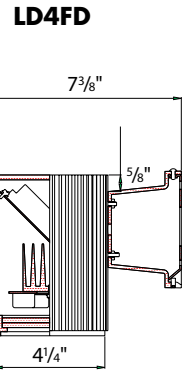
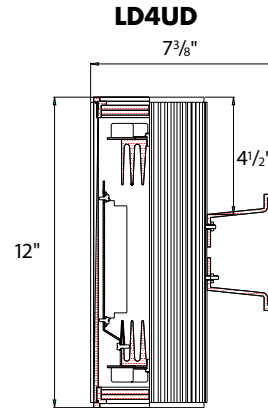

CATALOG NUMBER:

EXAMPLE: LD4FUDW Z

HOUSING	HOUSING STYLE	HOUSING ORIENTATION	LED COLOR	HOUSING FINISH
<input type="checkbox"/> LD4 4" HOUSING	<input type="checkbox"/> S Smooth <input type="checkbox"/> F Finned	<input type="checkbox"/> D Down <input type="checkbox"/> UD Up/Down	<input type="checkbox"/> W White <input type="checkbox"/> B Blue <input type="checkbox"/> R Red <input type="checkbox"/> C Cyan <input type="checkbox"/> G Green <input type="checkbox"/> A Amber	<input type="checkbox"/> WH White <input type="checkbox"/> BL Black <input type="checkbox"/> Z Zet

*Contact factory
for up/down
cylinders in two
colors.

PHOTOMETRIC DATA

LiteForms® LD4 4" Direct/Indirect LED Wall Mount Cylinder

DRIVER DATA

INPUT PARAMETER	VALUE	UNITS
Input Voltage range	108-132	V
Frequency	60 Hz	
Power Consumption		
Range	6.8-21.5	W
Efficiency	80	%

OUTPUT PARAMETER	VALUE	UNITS
Power Output Range	5.5-17.2	W
Output current	700(+/-35)	Ma
Total Harmonic Distortion	20 Max	Hz
Power Factor	0.9 Minimum	
Crest Factor LED Current	1.5 maximum	%
Output Voltage Range	7.8-24.6	V

1. Electrical characteristics at 25C ambient temperature
2. Output insulation 3.25KV 60Hz
3. FCC Class B

OPTICAL CHARACTERISTICS

Color Temperature*				Lumens
Color	Min.	Typ	Max.	TYP
White	4500 K	5500 K	6,500 K	38.3
Green	520 nm	530 nm	550 nm	45
Cyan	490 nm	505 nm	520 nm	38.3
Blue	460 nm	470 nm	490 nm	13.6
Red	620 nm	627 nm	645 nm	23
Amber	584 nm	590 nm	597 nm	21.2

*All white LED cylinders are shipped with a color corrective spread lens that maintains color temp at 5500K +/- 1000K.

LD4FUD

Lumileds Luxeon 6 ring (NWE7)
Fixture color temperature ~ 4,100K with color corrective lens.
Spacing Criteria= 0.3
Luminaire Efficiency= 71.8%
Total Initial Lumens= 228

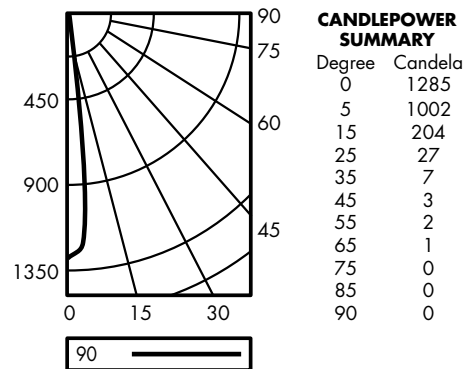

Test No. 1627

LUMINANCE DATA IN CANDELA/SQ. METER

Angle in Vertical	Average
45°	523
55°	430
65°	292
75°	0
85°	0

LD4FUD

AVERAGE INITIAL FOOTCANDLES

Assumptions:

1. Multiple Units (Square Array)
2. Ceiling 80% Wall 50% Floor 20%
3. 4 fixtures evenly spaced in the center of the room.
4. The room is square and has width and length equal to twice the lamp spacing.
5. The lumen depreciation factor is 0.8
6. the dirt depreciation factor is 0.98

1W SPACING	LED RCR1	RCR3	RCR7
7.0	3	3	2
8.0	2	2	2
9.0	2	2	1
10.0	1	1	1
11.0	1	1	1
12.0	1	1	1
13.0	1	1	1
14.0	1	1	1
15.0	1	1	1

Test No. 1627

COEFFICIENTS OF UTILIZATION Zonal Cavity Method

Room Cavity Ratio	% Effective Floor Cavity Reflectance																
	80%				70%				50%				30%		10%		
	20% Effective Floor Cavity Reflectance																
	% Wall Reflectance																
	70	50	30	10	70	50	30	10	50	30	10	50	30	10	50	30	10
1	83	81	80	79	81	80	79	79	77	76	75	74	74	73	72	72	71
2	80	78	76	74	79	77	75	73	75	73	72	73	71	70	71	70	69
3	78	75	73	71	77	74	72	70	72	71	69	71	69	68	69	68	67
4	76	72	70	68	75	72	69	67	70	68	67	69	67	66	68	66	65
5	74	70	67	65	73	70	67	65	68	66	65	68	66	64	66	65	64
6	72	68	65	63	71	68	65	63	67	65	63	66	64	62	65	63	62
7	71	66	64	62	70	66	63	62	65	63	61	64	62	61	64	62	61
8	69	65	62	60	68	64	62	60	65	62	60	63	61	60	63	61	59
9	68	63	61	59	67	63	60	59	62	60	59	62	60	58	61	60	58
10	66	62	59	58	66	62	59	58	61	59	57	61	59	57	60	59	57

NOTES

Refer to www.prescolite.com for additional photometric tests (IES Files).

*LEDs have inherent variances in light output of +/- 10% of rated lumens The above published data assumes a weighted average of 38.3 lumens/LED.



Web: www.prescolite.com • Tech Support: (888) 777-4832
701 Millennium Blvd., Greenville, SC 29607 U.S.A. • Phone (864) 678-1000
Copyright ©2007 Prescolite, Inc., a division of Hubbell Lighting, Inc. All Rights Reserved
Specifications subject to change without notice. • Printed in U.S.A. • LFO:LED-001 • 08/21/07

